

**SITE SURVEY DETAILS**

**PROJECT No:**

**SURVEYOR: TC**

**SITE: xxxx**

**SURVEY DATE: xx/xx/xxxx**

**PARKING:** Truck: **Yes** / No Van: **Yes** / No

**OFFLOADING:** Truck **Yes** / No Van: **Yes** / No

**VEHICLE / CRANE RESTRICTIONS:** Height Width **Weight – block paving  
CRANE SURVEY REQUIRED**

**SECURITY PASSES:** **Yes** / No - **Reception**

**SAFETY INDUCTION:** Yes / **No**

**POWER AVAILABLE:** **Yes** / No **Location: 240v internal**

**OPERATIVE ACCESS:** **Internal** / External

**EQUIPMENT REQUIRED:** Surveyor's ladder < 14' Yes / **No**  
Treble ladder < 20' **Yes** / No  
Cherry-Picker Yes / **No**  
Temporary Scaffold Yes / **No**

**F.B KEYS:** Yes / **No**

**WIND CALCULATIONS:**

Open country with no obstructions  
Open country with scattered wind breaks  
Small town, city outskirts/country (many windbreaks)  
City centres or equivalent

**Tick**

<input type="checkbox"/>
<input type="checkbox"/>
<input checked="" type="checkbox"/>
<input type="checkbox"/>

**COMP:** Yes / **No** Name: **NOT KNOWN**

Send quotations to:

Name	Company / Address	Email.	D/base Ref:
xxxx	xxxx	xxxx	xxxx

Future works recall set Yes / No  
2 No. sets of plans enclosed **Yes** / No  
2 No. sets of photos enclosed **Yes** / No  
Letter required (list of points attached) Yes / No  
Database updated **Yes** / No

**FORM COMPLETED IN FULL ..... Signed**

## NOTES

This is a large office block within the site and comprises of two large flat roofs with various smaller roofs around these areas. Two options are required: 1 - Full guardrail 2 - Budget option of demarcation/mobile man anchor combo. Both to include for vertical ladder, ladder hooks and restraint line system.

### FURTHER DETAILS

Access to the top main roof is via the two front internal passenger/goods lifts to the 3rd floor and then a further two flights of stairs to the roof access door to the left (photo 1). This door provides access into the plant area on the roof which is fully enclosed by a plant screen (note: the other door provides access into the other screened roof area but there is no main roof access from this area). Once through the screened off area the roof is relatively open but does have numerous plant located inbound from the roof edge.

The roof is inverted and built of a concrete deck. It has asphalt as a waterproofing beneath the roof finishes of insulation and 50mm pebbles. **NOTE: ANY GUARDRAIL INSTALLATION WILL HAVE TO ALLOW FOR AN EXTRA 50mm TO THE LEGS TO ALLOW FOR THE PEBBLE HEIGHT.**

Also located on the roof are several polycarbonate roof lights; although two skin and relatively low risk, they are deemed fragile and should be protected.

Around the front elevation there are two upper roof areas; one above the roof access front stair well and the other above the lift motor room - the client has also requested safe access to these areas. Above the stair well roof to the front and the lower rear enclosed rear stair well are AOV roof lights which are non-automatic closing and again deemed fragile with a potential fall risk. There is also a lower 2nd floor roof at the front which can be accessed from an office window.

At the far end of the Main roof are two 'Buttress' steel profile roof areas which are identical. Periodic access is required to clean out the associated box gutters, therefore a top fix line system should be allowed for.

The client would also like a price for a fixed vertical ladder from the main roof down into the rear lower stair well enclosed area.

The 1st floor lower roof area has much the same requirements and general layout as the Main roof area. Access onto this is via the rear access door from the 1st floor office area - this provides access to the entire area (apart from the area closed off by the walkway link). Again this roof has numerous plant, etc on the roof and a free standing fire escape walkway guardrail. Numerous roof lights are again in place on this roof and are identical to the roof. The area over the other side of the walkway link can be accessed via an office window.

The client would like two options.

A. Full System 2000 perimeter guardrail to all roofs inclusive of a top fix restraint system to the steel roof x 2 areas. Together with 4 No ladder hooks & 1 No access ladder.

B. BUDGET SCHEME - System 2000, Demarcation & Mobile Man Anchor (x2) combo to the Main Roof & 1st floor roof. All other roofs remain as Option A inclusive of restraint line to steel roof x 2. Together with 4 ladder hooks & 1 access ladder.

For both options System 2000 has been allowed for surrounding all roof lights and AOV'S.

Parking can be achieved on site.

Power is internal 240v.

Material access is best by a crane due to the potential quantity of materials, etc - however there really is only one location to the side, but this is primarily block paved with only a small area of tarmac to use - **CRANE SURVEY REQUIRED IF JOB PROGRESSES** - (out of hours crane lift)

Otherwise it will be by internal lifts (passenger x 2 to the front) & (two goods lifts, one at the front and one at the rear - however stairs will still have to be used to get to the areas).

**Photo 1**



## HEAD OFFICE

Safesite Limited  
Safesite House  
Priestley Way  
Crawley  
West Sussex  
RH10 9NA

t +44 (0) 1293 529977  
f +44 (0) 1293 531166

e info@safesite.co.uk  
t www.safesite.co.uk

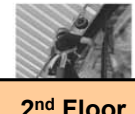

Registered Office  
Unit 2A  
Cradley Business Park  
Overend Road  
Cradley Heath  
West Midlands  
B64 7DW

Reg in England 2609468  
VAT Reg No 574 3626 24

**2nd Floor  
Balcony Roof**

**Front Stair  
Well Roof**

**Lift Motor  
Room Roof**

**1st Floor  
Roof**

**Rear Stair  
Well Roof  
(Lower  
Enclosed Area)**

*1st Floor  
Extension Roof*

1200mm High  
Parapet Wall

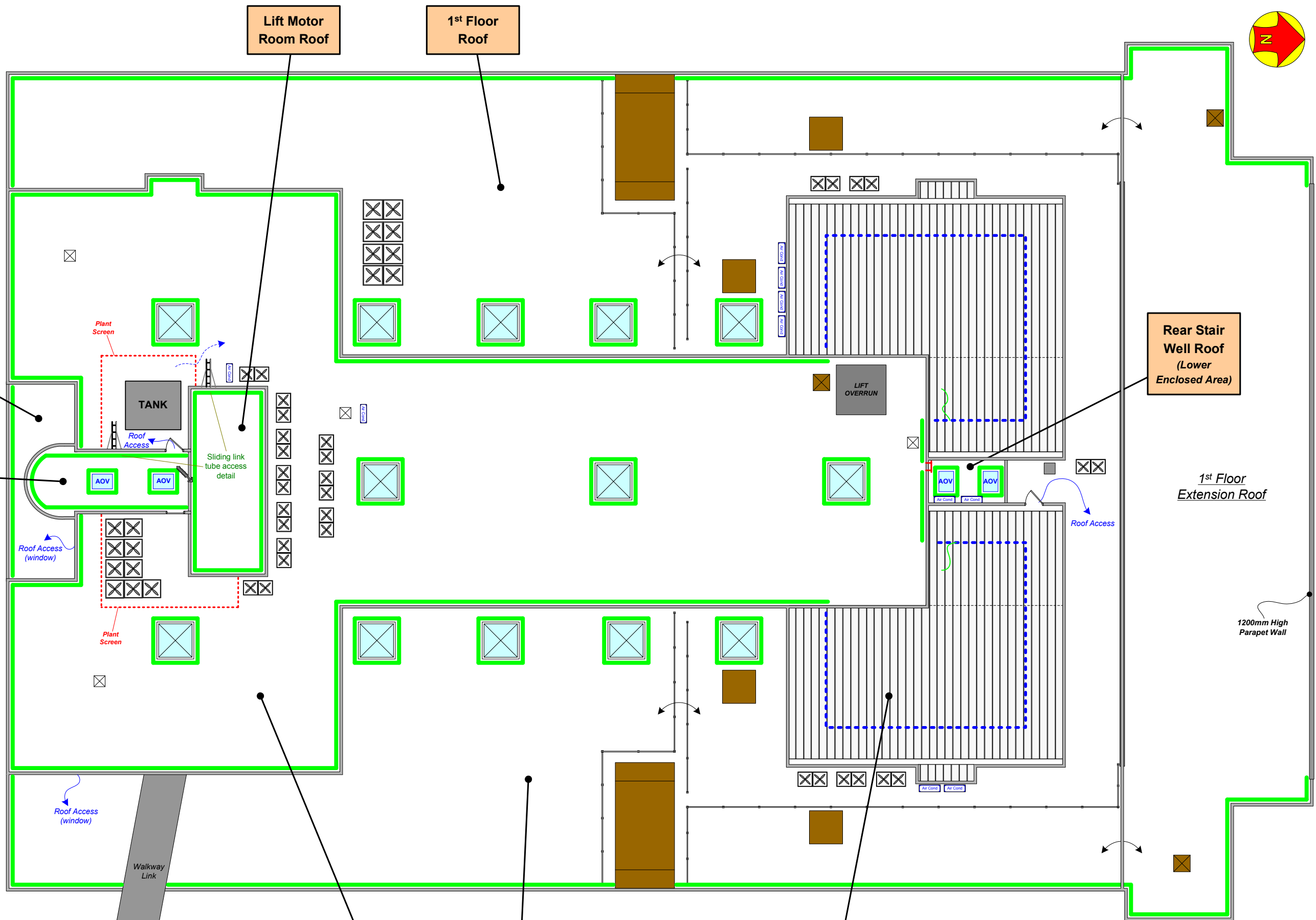

**OPTION A**

General Notes	
	Ladder Restraint Hooks
	Free standing guardrail
	New fixed vertical access ladder
	Horizontal 'Restraint' line system
Drg. Title	
Client	
Drg. No	
Date	Drawn T. C
Revision	Scale N. T. S

- The falls from height protection scheme comprises of;
1. System 2000 free standing guardrail to leading edges on all roof levels and to fragile roof light/AOV surrounds therefore preventing all potential fall risks.
  2. A stainless steel horizontal 'Restraint' line system riveted to the top roof sheet providing safe access to the gutters on the Steel Profile Roofs (x2) on the Main Roof.
  3. A new fixed vertical access ladder providing safe access down to the Rear Stair Well Area from The main Roof above.
  4. Ladder Restraint Hooks resin fixed into the outer leaf brick to provide safe mobile ladder access up onto the Front Stair Well Roof and Lift Motor Room Roof when used in conjunction with the proposed ratchet straps.

## HEAD OFFICE

Safesite Limited  
Safesite House  
Priestley Way  
Crawley  
West Sussex  
RH10 9NA

t +44 (0) 1293 529977  
f +44 (0) 1293 531166

e info@safesite.co.uk  
t www.safesite.co.uk

Registered Office  
Unit 2A  
Cradley Business Park  
Overend Road  
Cradley Heath  
West Midlands  
B64 7DW

Reg in England 2609468  
VAT Reg No 574 3626 24



**2<sup>nd</sup> Floor  
Balcony Roof**

**Front Stair  
Well Roof**

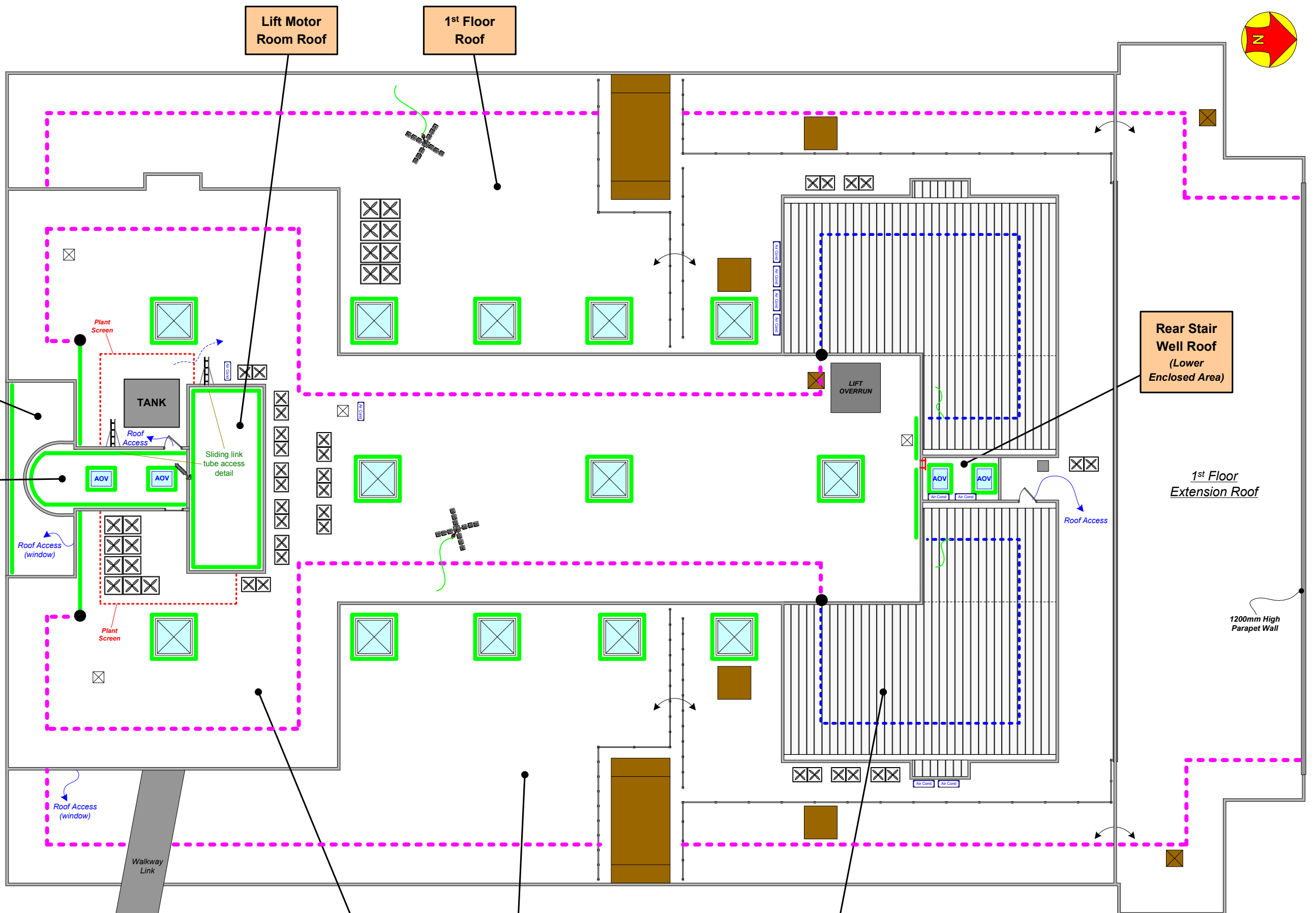

**OPTION B**

General Notes	
	Ladder Restraint Hooks
	Free standing guardrail
	New fixed vertical access ladder
	Horizontal 'Restraint' line system
	Demarcation
	MOBILE MAN ANCHOR

<b>Drg. Title</b>	
Budget Scheme	
<b>Client</b>	
<b>Drg. No</b>	
<b>Date</b>	<b>Drawn</b> T . C
<b>Revision</b>	<b>Scale</b> N . T . S

- The falls from height protection scheme comprises of;
1. System 2000 free standing guardrail to leading edges within 2m of a potential fall risk and to fragile roof light/AOV surrounds therefore preventing potential fall risks.
  2. A stainless steel horizontal 'Restraint' line system riveted to the top roof sheet providing safe access to the gutters on the Steel Profile Roofs (x2) on the Main Roof.
  3. A new fixed vertical access ladder providing safe access down to the Rear Stair Well Area from The main Roof above.
  4. Ladder Restraint Hooks resin fixed into the outer leaf brick to provide safe mobile ladder access up onto the Front Stair Well Roof and Lift Motor Room Roof when used in conjunction with the proposed ratchet straps.
  5. Demarcation set back 2m minimum to the leading roof edges on the Main and 1<sup>st</sup> floor Roofs thus preventing entry to hazardous/unguarded roof edges.
  6. An individual Mobile Man Anchor (MMA) x 2 to be positioned within the Demarcation for safe access beyond the Demarcation when used with the proposed PPE.